

MODEL:1812GFN20



输出功率：约0.1~1.5W
精密金属蜗杆齿轮减速电机

OUTPUT:APPROX 0.1~1.5W
Precision Metal Worm Gear Motor

典型应用： 电子门锁
智能家居
智能机器人
家用电器

Typical Applications: Electronic Door Lock
Smart Home
Smart Robot
Household Appliances

1.OUTLINE DRAWING:

UNIT:MM

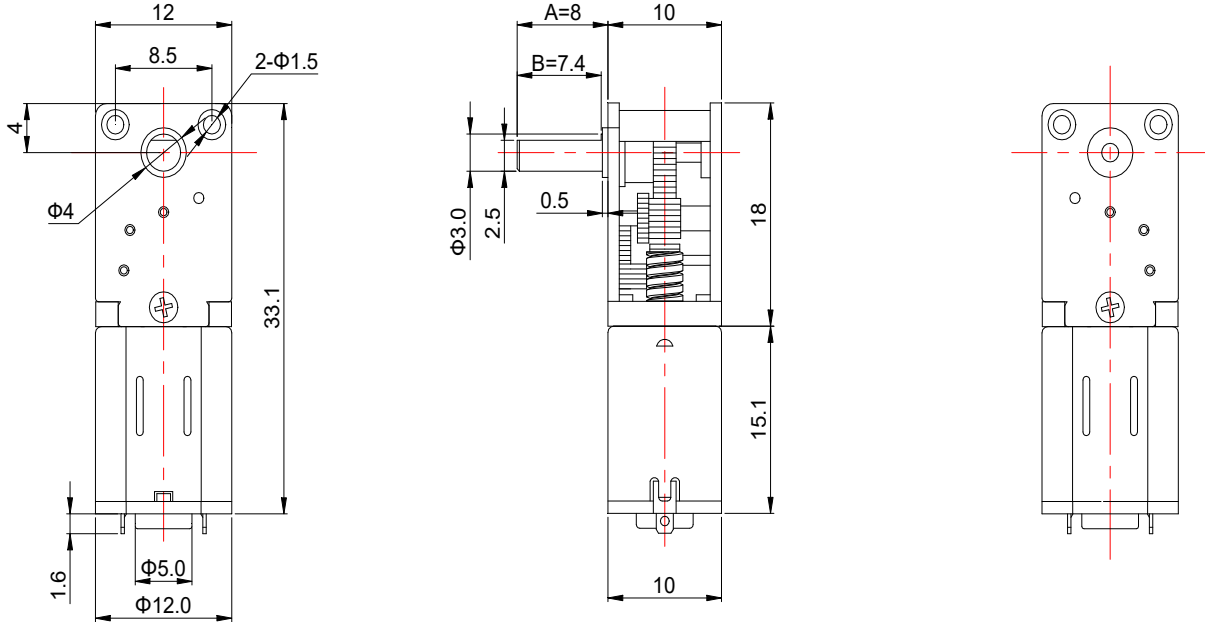

Customizable Parameters:

1. Length A and B ,Double out the shaft
2. Electric Performance
3. Output shaft specifications
4. Reduction Ratio
5. Encoder can be added

WEIGHT: 13.0g(Approx)

View:



2.GEARBOX REDUCTION RATIO:

Gearbox Length (mm)	Stage Number	Reduction Ratio						Rated Troque	Bea Maxi Instant
		g.cm							
18	4	20/1	40/1	120/1	235/1	300/1	600/1	1000	2000

3.MOTOR PERFORMANCE :

1mN.m≈10.2g.cm≈0.142

FF-N20TA (Metal brushes) 3.0VDC 12000rpm

MODEL	REDUCTIO N RATIO	VOLTAGE		NO LOAD		AT MAXIMUM EFFICIENCY				ST.
		OPERATING RANGE	NOMINA	SPEED	CURREN	SPEED	CURREN	TORQUE	OUPUT	TORQUE
			V	rpm	A	rpm	A	g.cm	W	g.cm
1812GFN20-20-03600	20/1	2.0~4.0	3.0	600	0.04	470	0.15	35	0.17	158
1812GFN20-40-03400	40/1	2.0~4.0	3.0	400	0.04	236	0.15	65	0.16	320
1812GFN20-120-03100	120/1	2.0~4.0	3.0	100	0.04	78	0.15	200	0.16	950
1812GFN20-235-0350	235/1	2.0~4.0	3.0	50	0.04	40	0.15	400	0.16	1900
1812GFN20-300-0340	300/1	2.0~4.0	3.0	40	0.04	31	0.15	500	0.16	2370
1812GFN20-600-0320	600/1	2.0~4.0	3.0	20	0.04	15	0.15	1000	0.15	4740

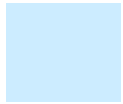

M

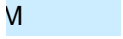

3

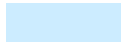

vable
imum
Torque

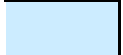

000

oz.in



ALL

CURREN

A

0.56

0.56

0.56

0.56

0.56

0.56