



输出功率: 约0.5~20W
精密金属齿轮减速电机

典型应用: 智能家居
智能机器人
自动售货机
阀门

OUTPUT: APPROX 0.5~20W
Precision Metal Gear Motor

Typical Applications: Smart Home Appliance
Smart Robot
Vending Machine
Valve

1. OUTLINE DRAWING:

UNIT:MM

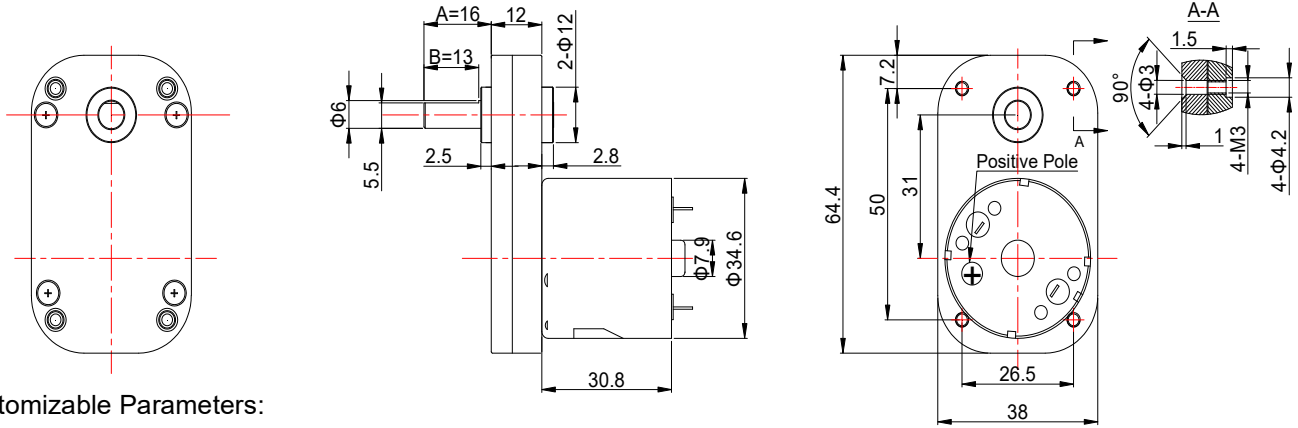

Customizable Parameters:

1. Length A and B
2. Electric Performance
3. Output shaft specifications
4. Reduction Ratio

WEIGHT: 210g(Approx)

View:



2. GEARBOX REDUCTION RATIO:

Gearbox Length (mm)	Stage Number	Reduction Ratio						Rated Torque	Bearable Maximum Instant Torque
		kg.cm							
64.4 x 38 x 12	3	36/1	40/1	60/1	67/1			3.0	6.0
	4	85/1	90/1	114/1	120/1	200/1		6.0	10.0
	4	96/1	101/1	128/1	135/1	225/1		8.0	15.0
	5	400/1	450/1					10.0	20.0

3. MOTOR PERFORMANCE :

1N.m≈10.2kg.cm≈14.2oz.in

MODEL	REDUCTION RATIO	VOLTAGE		NO LOAD		AT MAXIMUM EFFICIENCY				STALL	
		OPERATING RANGE	NOMINA	SPEED	CURRENT	SPEED	CURRENT	TORQUE	OUTPUT	TORQUE	CURRENT
			V	rpm	A	rpm	A	kg.cm	W	kg.cm	A
38GF3530-36-12180	36/1	5.0~14.0	12.0	180	0.09	152	0.8	2.0	3.12	13.5	4.5
38GF3530-67-1296	67/1	5.0~14.0	12.0	96	0.09	80	0.8	4.2	3.45	26.2	4.5
38GF3530-135-1248	135/1	5.0~14.0	12.0	48	0.09	42	0.64	6.5	2.80	52.0	4.5
38GF3530-450-1214	450/1	5.0~14.0	12.0	14	0.1	12.5	0.64	15.0	1.92	145.0	4.5